

LOGSTOR FXC

Installation Instructions - Industry



Installing open joint FXCJoint

Application

FXCJoints are i.a. used as repair joints in freely suspended systems.

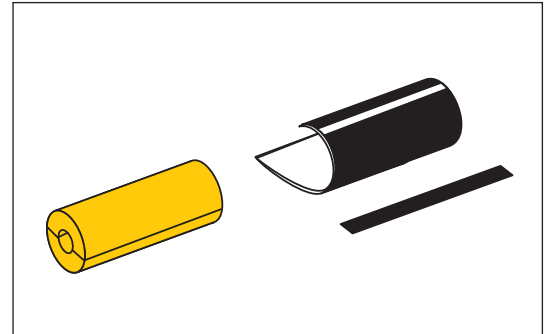

Installation tips

Important:

Never heat directly on any creases, otherwise the surface of the shrink wrap may discolour and crack at the surface.

Never heat under the wrap at the ends, otherwise the wrap may be damaged permanently.

Use burner head $\varnothing 50\text{mm}$ for shrink wrap up to $\varnothing 210\text{ mm}$. For larger shrink wraps use burner head $\varnothing 60\text{ mm}$.

Installation

1. Heat the entire old shrink sleeve..

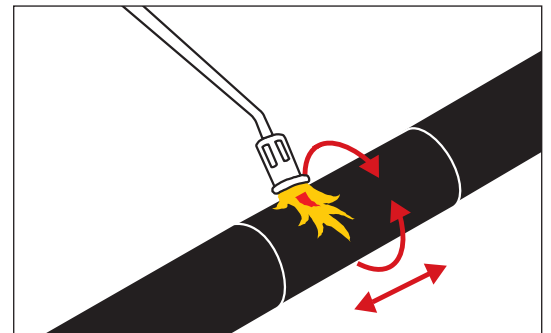

2. Cut the old shrink sleeve longitudinally with a sharp knife. Remove the shrink sleeve.

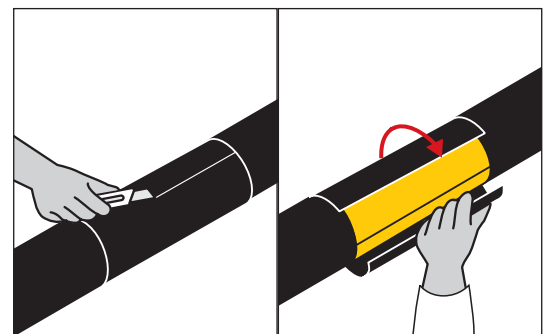

3. Clean all surfaces in the jointing area.

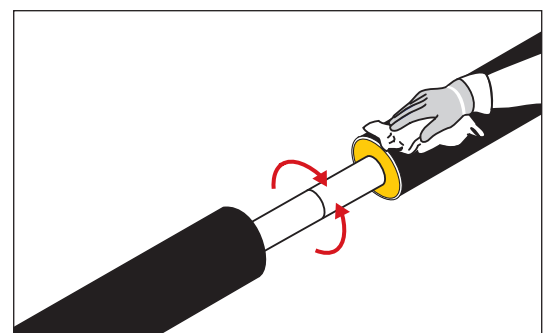

Installing open joint FXCJoint

Installation, continued

4. Shorten the insulation shells so they fit tightly between the casing pipes.

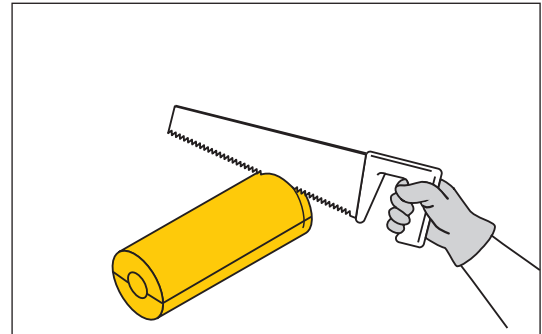

5. Install the insulation shells tightly between the casing pipes, using adhesive tape, if required.
All surfaces must be CLEAN and DRY.
Now clean the casing surface with alcohol.

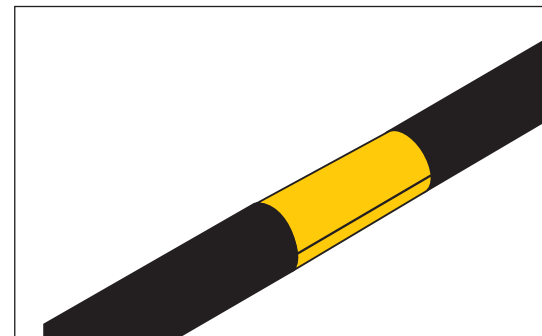

6. Activate the casing pipes with emery cloth (grain size 60 up to \varnothing 280 mm and grain size 36 for major dimensions), so grind marks will be visible outside the rim of the shrink wrap.
Remove grind dust, if any, and avoid touching the ground contact surfaces.

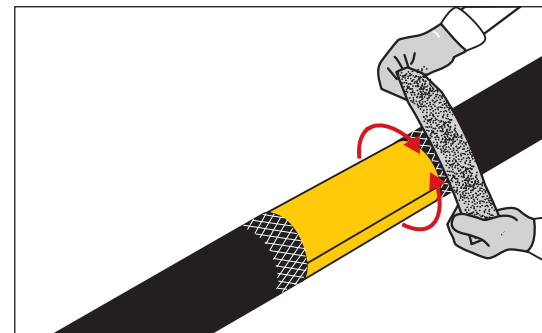

7. Activate the casing pipes with gas burner to a surface temperature of min. min. 65°C.

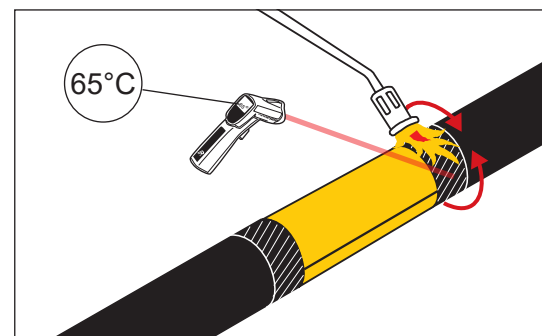

8. Remove the paper from the shrink wrap, while pulling the wrap into position.
The text must go around the pipe, and the joint must be at the top.
The wrap must fit loosely around the pipe with an overlap of min. 50 mm.

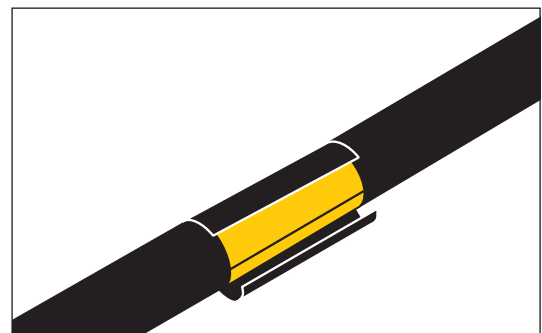

Installing open joint FXCJoint

Installation, continued

9. Centre the closure patch on the wrap joint with the adhesive side facing down. The adhesive side has a visible reinforcement. Heat the closure patch until the reinforcement structure becomes visible on the top side. Press down the closure patch. Now roll on the closure patch with the roller to ensure good adhesion. Alternatively, use a patch press.

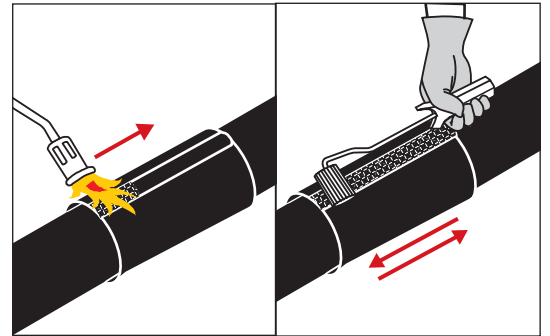

10. Shrink the wrap from the centre towards both ends, ensuring that sealing compound spreads to all ends, and the full shrinking effect has been utilised.

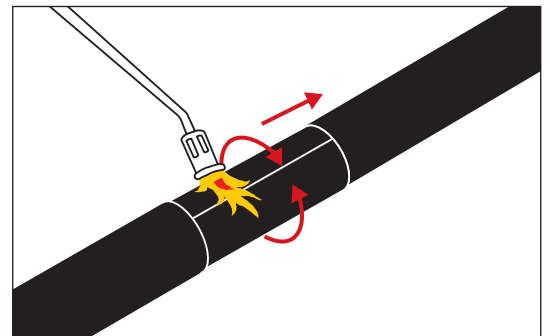

11. Roll along the overlapping edge, ensuring that any tunnel is sealed with sealing compound.

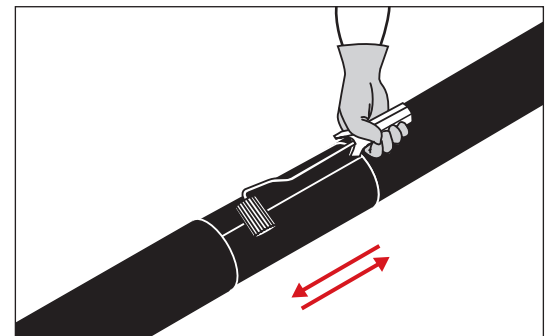

12. The joint is complete.

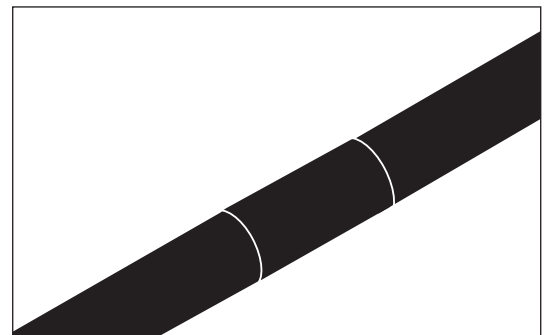

Contact details

Denmark

LOGSTOR Denmark Holding ApS
Danmarksvej 11 | DK-9670 Løgstør

T: +45 99 66 10 00
E: logstor@kingspan.com



For the product offering in other markets please contact your local sales representative or visit www.logstor.com

Care has been taken to ensure that the contents of this publication are accurate, but Kingspan Limited and its subsidiary companies do not accept responsibility for errors or for information that is found to be misleading. Suggestions for, or description of, the end use or application of products or methods of working are for information only and Kingspan Limited and its subsidiaries accept no liability in respect thereof.

To ensure you are viewing the most recent and accurate product information, please scan the QR code directly above.

